

Mini Maintenance Kit

Part #:
PJDI120VMINI-H
D40MZZ -40 GPM
D8RE2 - 40 GPM



GENUINE
DOSATRON
PARTS

1-800-523-8499
www.dosatronusa.com



LIT-EN-PJDI120VMINI-H

Kit Contents:

(1) **JDI121:**
Plunger seal



(1) **PDI756:** Top Guide



(1) **PDI752:**
Check Valve
Cone



(1) **MDI359:** Check
Valve Spring



(1) **JDI131:**
Check Valve
Cone O-Ring



(1) **DOSA-LUBE:**
Silicone



Use **Dosa-Lube** on
specified parts only.



CAUTION: Parts may contain concentrated chemicals. The use of Proper Protective Equipment is recommended when performing maintenance.

Instructions

(Parts included in kit noted in blue)

Disassembly

1. Unscrew hose nut (PDI748) and remove the hose.

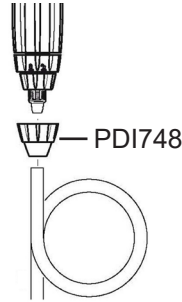

2. Unscrew the check valve nut (PDI747). Remove the check valve assembly (PJDI118) by pulling it down.

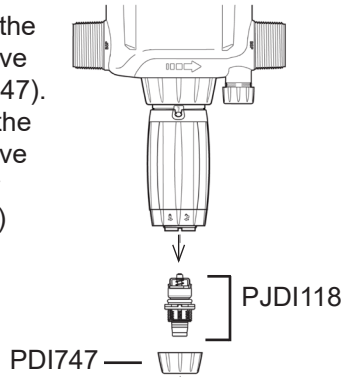

3. Take off the top guide (PDI756) by giving it a 1/4 turn counter clockwise, and discard. Discard the check valve spring (MDI359), check valve cone (PDI752) and check valve cone o-ring (JDI131).

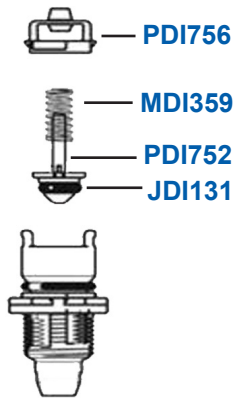

4. Unscrew injection stem assembly nut (PDI702) and pull down on the injection stem assembly (8CD033) to detach from the body of the unit.

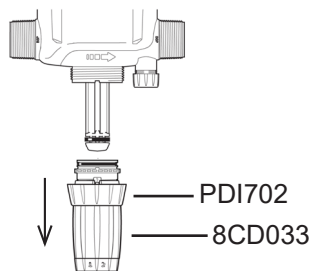

5. Unscrew the locking nut (PDI702) from the injection stem assembly (8CD033) and remove the black anti-rotation lock (PDI751) by spreading it apart, then slide it down over the threads of the injection stem (PDI753).

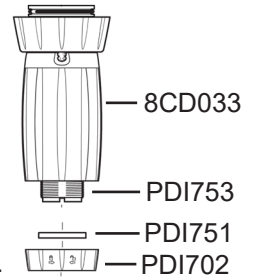

6. Unscrew the adjusting sleeve (PPDI037) until it comes off. Hold the black sleeve (8P159) and push up on the threaded part of the white injection stem (PDI753). Then slide it out of the black sleeve (8P159) from the top.

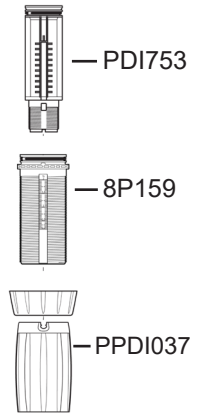

7. Unscrew the upper bell housing (8MP039) and remove the piston assembly (8PC002) out of the unit.

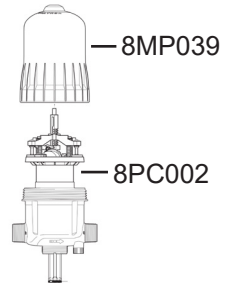

8. From the tip of the plunger (PJDI119), remove the plunger seal (JDI121), pinch the seal, roll it off, then discard.

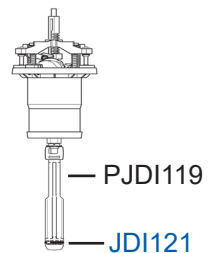

NOTE: Reassembly instructions on back.

Reassembly

9. Using the **Dosa-Lube** provided in the kit, rub a small amount onto the injection stem o-ring (JDI122) and the black stem o-ring (JDI100).

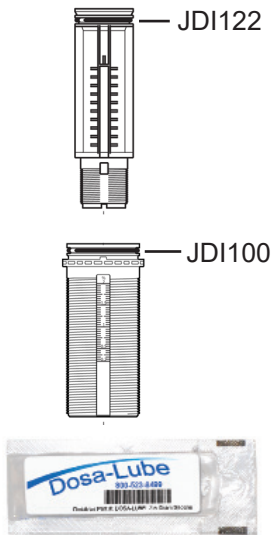

10. Slide the white injection stem (PDI753) down into the black sleeve (8P159), making sure the key inside the sleeve is aligned with the groove on the white injection stem. Pull down on the white injection stem (PDI753) as far as it will go.

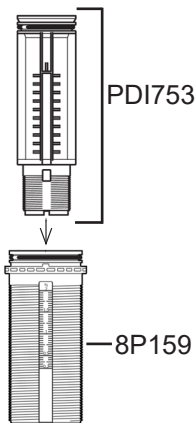

11. Slide the injection stem assembly nut (PDI702) onto the black sleeve (8P159). Then screw the adjusting sleeve (PPDI037) back onto the black injection sleeve (8P159).

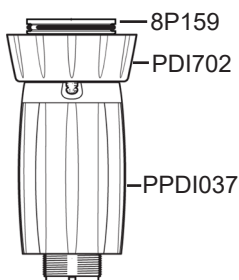

12. Reinstall the "C" clamp (PDI751) by gently sliding it over the threads at the bottom of the white injection stem (PDI753). Screw back the locking nut (PDI733).

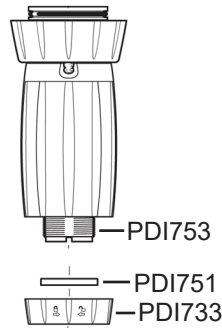

13. Take the new check valve cone (PDI752) and install the new check valve cone o-ring (JDI131). Place the cone part going down into the check valve barb (PDI742). Insert the new check valve spring (MDI359) onto the rod of the check valve cone (PDI752), place the new top guide (PDI756) on top and push down, then turn 1/4 clockwise until the top guide locks into the check valve barb (PDI742). Apply **Dosa-Lube** on the check valve o-ring (20J002). **NOTE:** Do not apply **Dosa-Lube** inside the check valve.

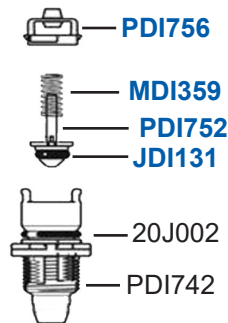

14. Insert the new check valve assembly (PDI747) back into the bottom of the injection stem assembly (8CD033) and screw the check valve nut (PDI747) back on.

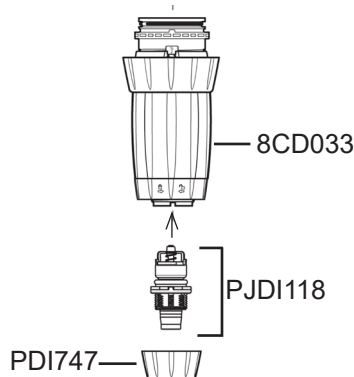

15. Take the new plunger seal (JDI121) and place it on the groove of the plunger (PDI119) at the bottom of the piston.

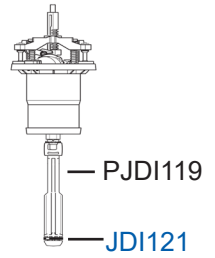

16. Insert the piston assembly (8PC002) into the lower housing (8PP010NPT), then screw the upper bell housing (8MP039) back in place.

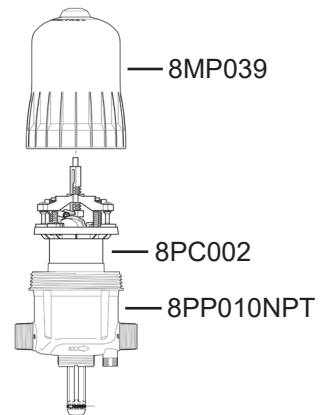

17. Attach the injection stem assembly (8CD033) to the bottom of unit making sure the teeth on the sleeve fit into the grooves of the blue body. Screw the injection stem nut (PDI702) back on.

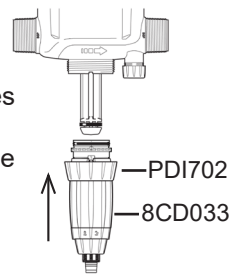

18. Cut 1" off from the top of the suction hose to ensure a tight fit, make sure to cut in a straight line. Attach the hose and the hose nut (PDI748) back to the unit.

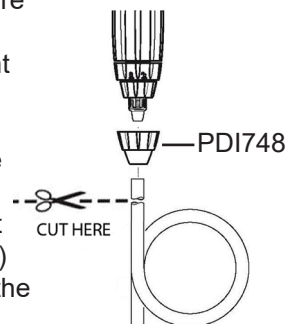

! Don't forget to reset your injection rate to the proper ratio.